

RAIL

Sew Steady®

ELEVATE YOUR CREATIVITY

## Add-A-Drawer INSTRUCTIONS

USE THIS INSTRUCTION SHEET AS TEMPLATE

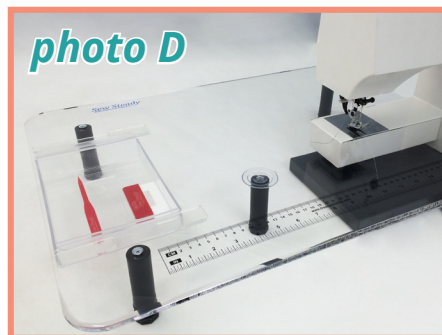
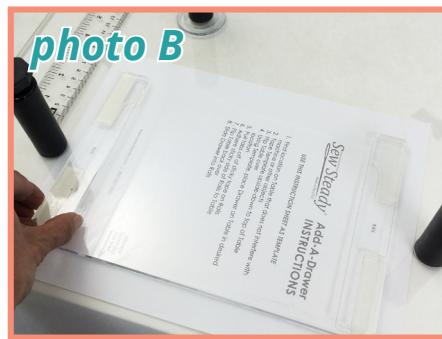
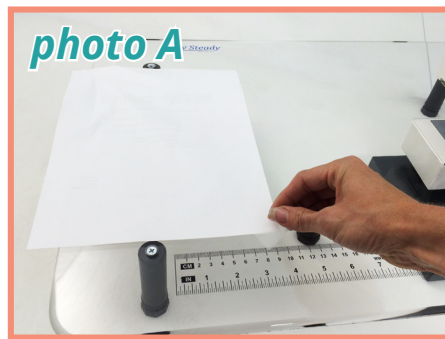

**DRAWER  
SLIDES OUT  
THIS WAY**

1. Find location on Table that does not interfere with machine or other objects (*see photo A*)
2. Tape Template upside-down to top of Table (*see photo B*)
3. Flip Table over
4. Using Template, place Drawer on Table in desired location (*see photo C*)
5. Pull tabs off of sticky tape on Rails
6. Adhere sticky side of Rails to Table
7. Flip Table back over
8. Slide Drawer into Rails (*see photo D*)

[www.sewsteady.com](http://www.sewsteady.com) | 800-837-3261

RAIL