

Sew Steady®

ELEVATE YOUR CREATIVITY

Circle Sewing Tool

For Use with: Deluxe & Wish Tables

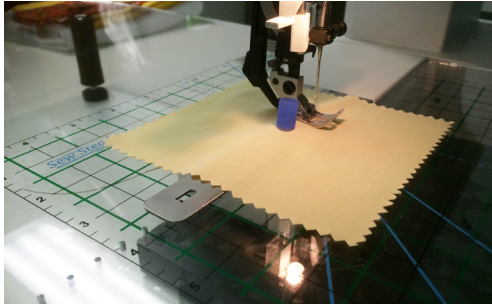

INCLUDES:
4" Metal Tool,
1 Pinmoor



Sew Steady®

ELEVATE YOUR CREATIVITY

Circle Sewing Tool

For Use with: Deluxe & Wish Tables

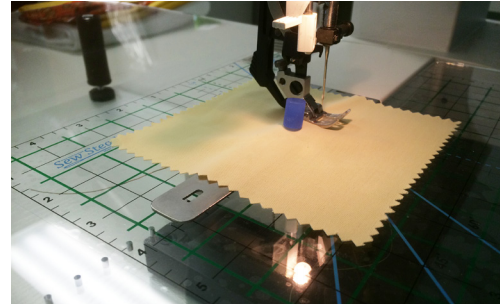

INCLUDES:
4" Metal Tool,
1 Pinmoor



Sew Steady®

ELEVATE YOUR CREATIVITY

Circle Sewing Tool

For Use with: Deluxe & Wish Tables

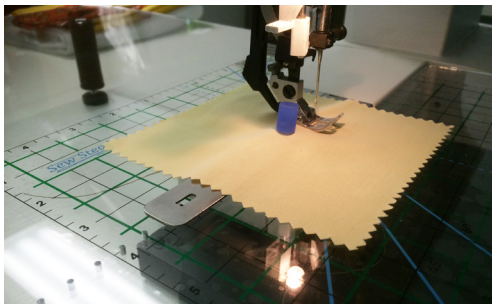

INCLUDES:
4" Metal Tool,
1 Pinmoor



Sew Steady®

ELEVATE YOUR CREATIVITY

Circle Sewing Tool

For Use with: Deluxe & Wish Tables

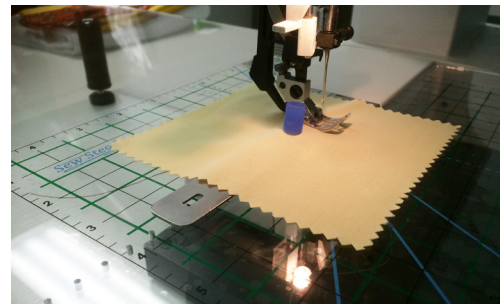

INCLUDES:
4" Metal Tool,
1 Pinmoor





1. Remove the Blue pinmooor from needle.
2. Determine center point of circle and pin onto needle.
3. Reattach pinmooor.
4. Determine ideal circle size using grid or centering ruler.
5. Insert the two metal prongs into adjacent holes evenly spaced 3/8" apart in the Deluxe or Wish Table.
6. Secure pinmooor and select decorative or straight stitch.

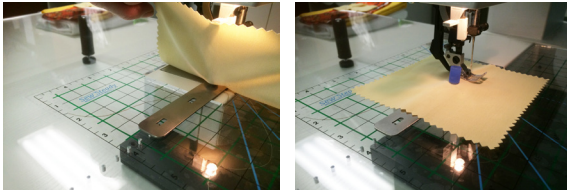

1. Remove the Blue pinmooor from needle.
2. Determine center point of circle and pin onto needle.
3. Reattach pinmooor.
4. Determine ideal circle size using grid or centering ruler.
5. Insert the two metal prongs into adjacent holes evenly spaced 3/8" apart in the Deluxe or Wish Table.
6. Secure pinmooor and select decorative or straight stitch.

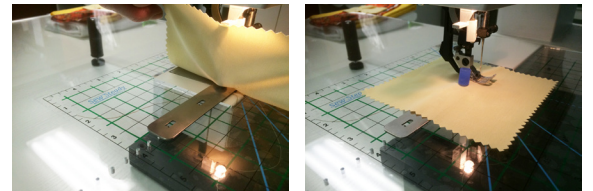

1. Remove the Blue pinmooor from needle.
2. Determine center point of circle and pin onto needle.
3. Reattach pinmooor.
4. Determine ideal circle size using grid or centering ruler.
5. Insert the two metal prongs into adjacent holes evenly spaced 3/8" apart in the Deluxe or Wish Table.
6. Secure pinmooor and select decorative or straight stitch.

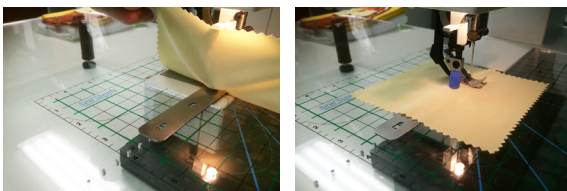

1. Remove the Blue pinmooor from needle.
2. Determine center point of circle and pin onto needle.
3. Reattach pinmooor.
4. Determine ideal circle size using grid or centering ruler.
5. Insert the two metal prongs into adjacent holes evenly spaced 3/8" apart in the Deluxe or Wish Table.
6. Secure pinmooor and select decorative or straight stitch.

