

Fun with Tecoma & Tecoma Echo Templates



Westalee
DESIGN

Gold Accredited Teacher

Donelle McAdams

Email: sewbiz@indy.rr.com

Sew Steady
WWW.SEWSTEADY.COM
ELEVATE YOUR CREATIVITY

May not be reproduced in any format without permission.

Fun with Tecoma & Tecoma Echo Templates

Description: Once you try the Tecoma Templates, you will open a whole new creative area of designing with quilting Templates! YES! They look complicated; however, Donelle will take you step-by-step through the design and teach you how to manipulate the templates. You will also learn how to do TempLee Quilting in this very versatile project. The completed design is a 16" square, but you can modify this design to be larger or smaller. Other options will be shown in class so that you can get the most from these amazing templates. This will make a great item for your home or quick gift for a family member or friend.

Templates & Tools: All are available from Sew Steady

Tecoma Template Set (2 pc.) to 12"

Tecoma Echoes Template Set (4 pc.)

6 Point Cross Hair Square

Mini Spin-E-Fex #10

12 1/2" Centering Ruler by Sew Biz

1/2" Ruler Work Foot

The Ranges Book by Leonie West

Available from Sew Biz:

Quick Easy Mitered Binding Tool by Sew Biz

Fabric:

20" square for backing

16" square for front

16" square for 'peeker' fabric

16" square Templee Fuse or similar

16" square batting

100% Polyester Quilting thread

#90 Top-Stitch Needle



Sew Steady
WWW.SEWSTEADY.COM
ELEVATE YOUR CREATIVITY

Donelle McAdams

765-661-1458

sewbiz@indy.rr.com



Instructions

1. Use the 6 pt. Cross Hair Square to draw the first 6 lines. Notice that it is positioned with VERTICAL lines. Mark these lines with SOLID LINES.

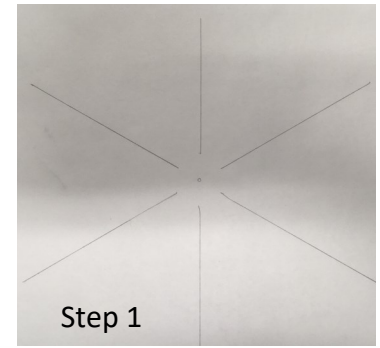

2. Rotate the Cross Hair Square to position for lines exactly half way between the original lines. Mark these lines with SOLID LINES.

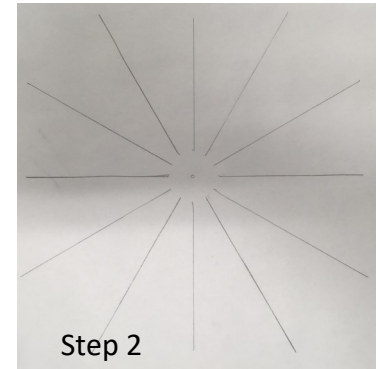

3. Rotate the Cross Hair Square to line up for markings half way between the markings in Step 2. This will only be for half of the sections. Mark these lines with DASHED LINES.

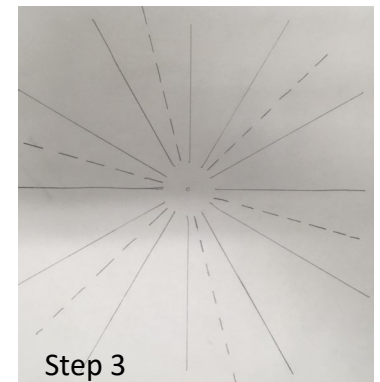

4. Rotate Cross Hair Square again and make the remaining DASHED LINES.

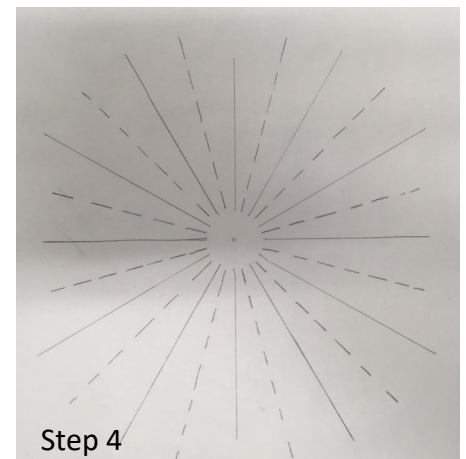

5. Place a thumb tack in the CENTER of the markings. Using the T1 Tacoma Template, position as shown.

6. The STITCHING will start on a DASHED LINE. The Template will be lined up on a SOLID LINE.

NOTE: Place a BLUE Ruler Sticker on the Template as shown. On the opposite side place a PINK Ruler Sticker. This will be shown in class. The Stickers go on the line with the MULTIPLE ARROWS etched in the template.



7. Lined up on the SOLID Line, stitch from the DASHED LINE to the SOLID line and stop with the needle DOWN.
8. Flip the template over and position as shown. You will be lining up the PINK arrow on the SAME SOLID Line. Stitch from the SOLID Line to the DASHED LINE and stop with the needle DOWN. This process will be repeated to make 12 scallops.

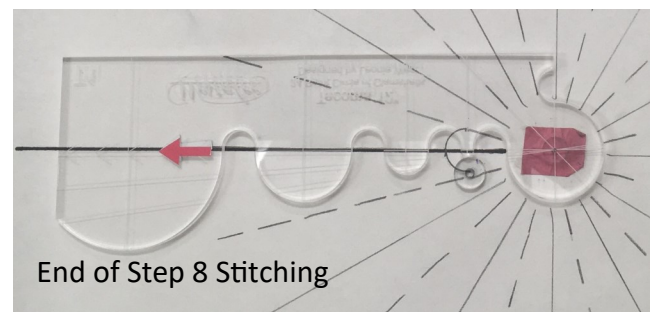
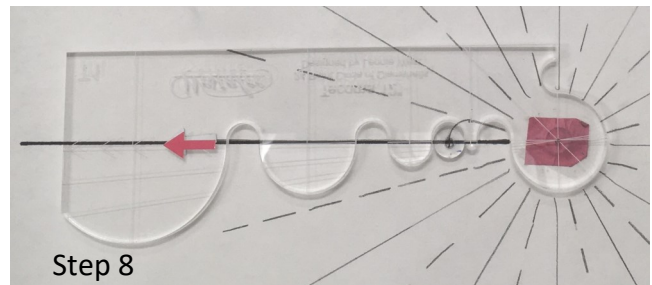

9. Flip the template over, position BLUE arrow on next SOLID line and stitch to the SOLID Line and stop with the needle DOWN.

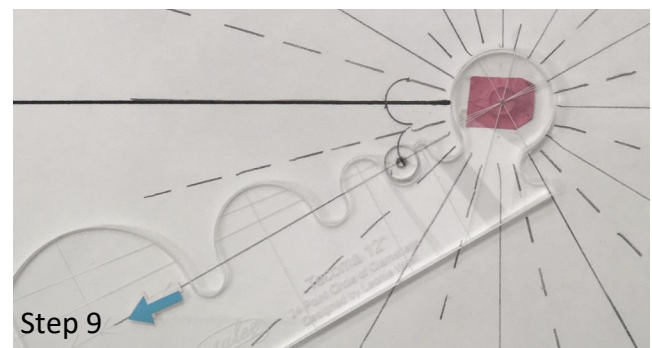

- 10 Flip the templat over, position the PINK arrow on the SAME SOLID line and stitch to the DASHED Line and stop with the needle DOWN. When you have returned to the starting point, **SECURE THREADS** and remove the thumb tack.

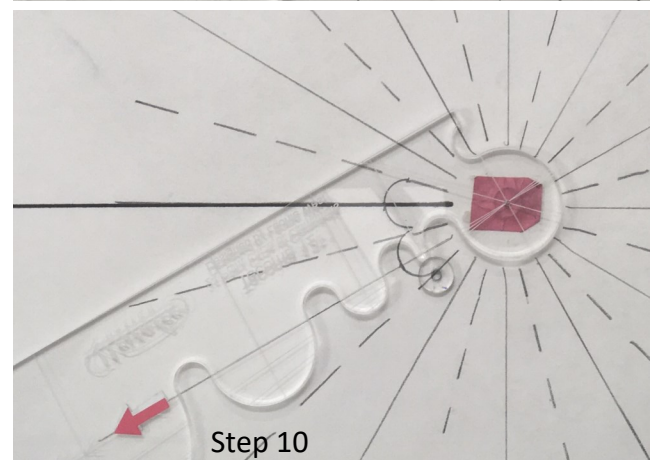

11. Completed section of the design.

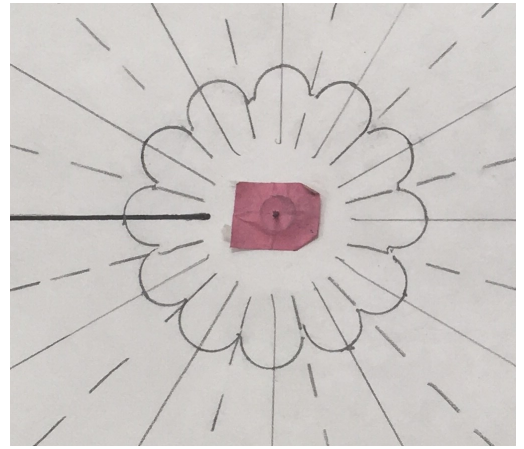

12. Using the 2 1/2" Mini Spin-E-Fex #10 Template, position the WIDE end nearest the center. Bring up bobbin thread in the center of the Cross Hairs. Stitch around the design template.

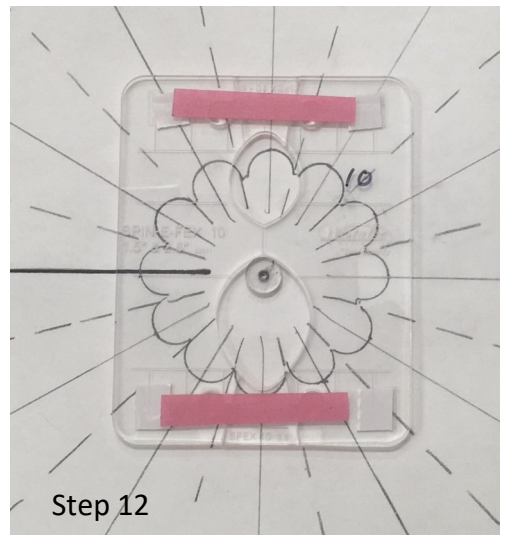
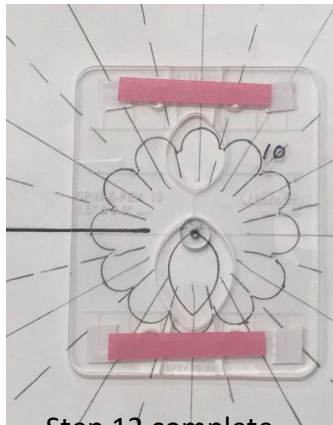

13. Rotate the template 180° and stitch again.

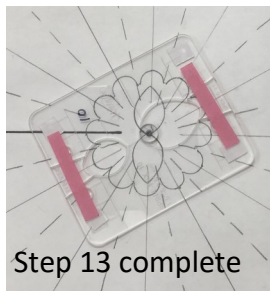

14. Stitch this design on only 6 SOLID cross hair lines. Skip a SOLID Line and stitch again. Continue until there are 6 evenly spaced petals.

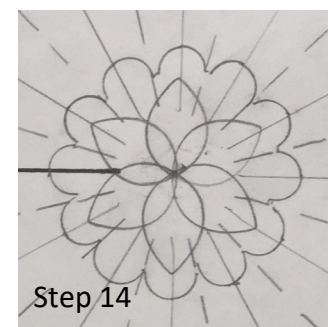

15. Place thumb tack in the center of the design.

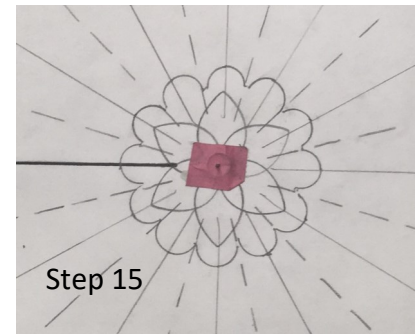

16. Using the T1 Tacoma Template, position as shown in diagram. The side with the PINK arrow will be positioned on a DASHED line for this step. Bring up bobbin thread and stitch to the SOLID LINE and stop with the needle down.

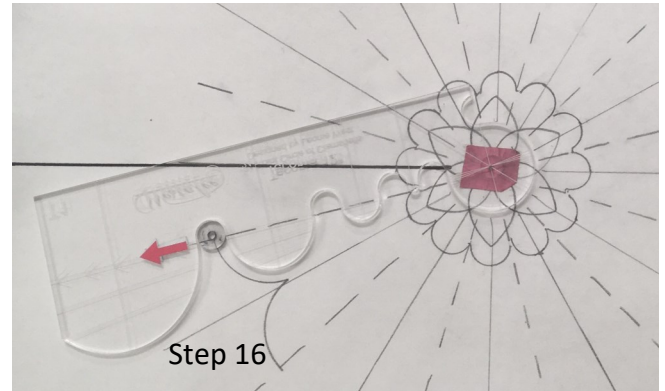

17. Flip the template over and line the BLUE arrow up with the DASHED line and stitch to the DASHED line. Continue until you are back to the starting position. SECURE THREADS.

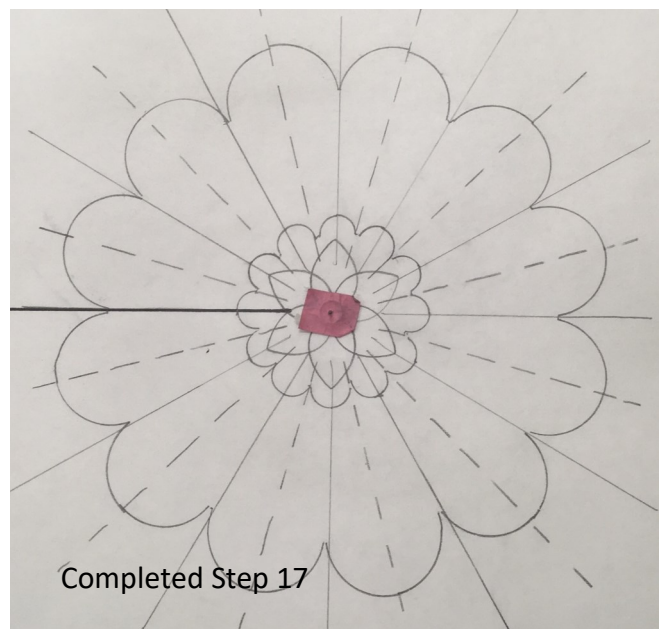
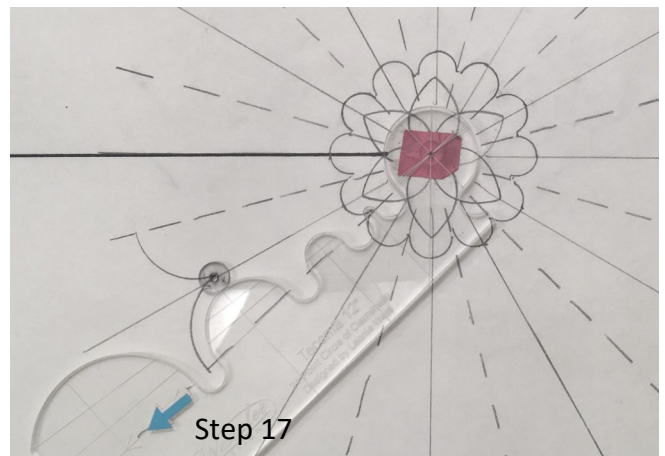

18. Using a Spacing Gauge and a Straight Edge Template, bring up the bobbin thread in one of the 'dips' of the outer design.

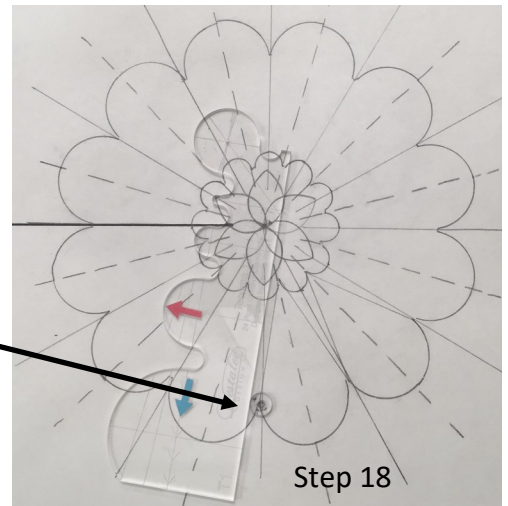

19. Stitch from the 'dip' in the outer design to the 'dip' in the inner design.

20. Reposition template, measure and stitch back to the 'dip' in the outer design and continue around the complete design. SECURE THREADS.

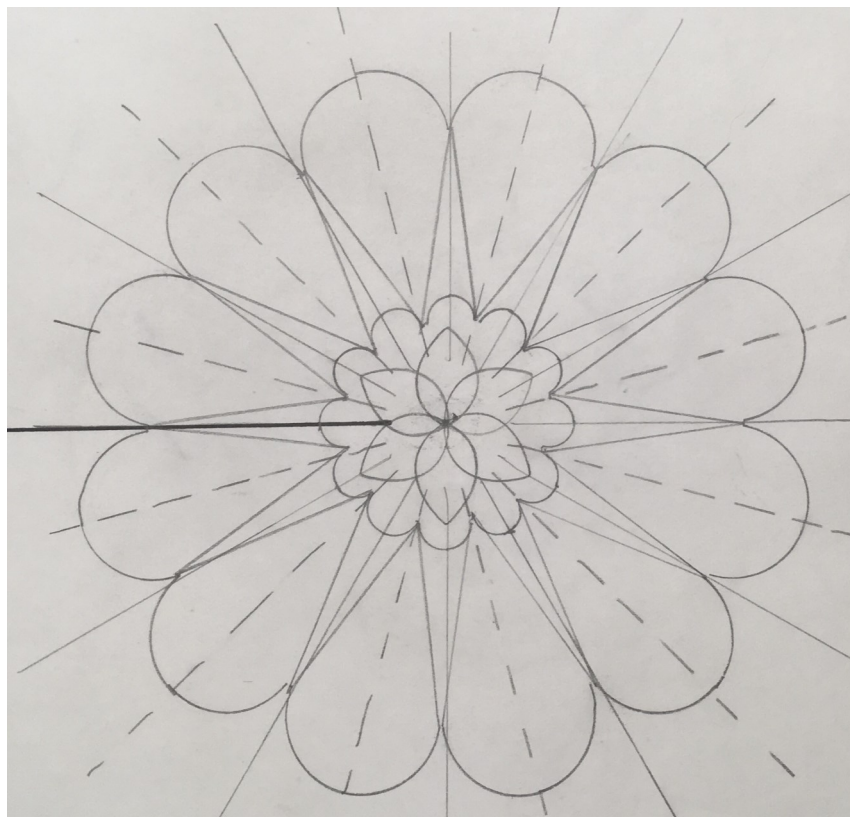
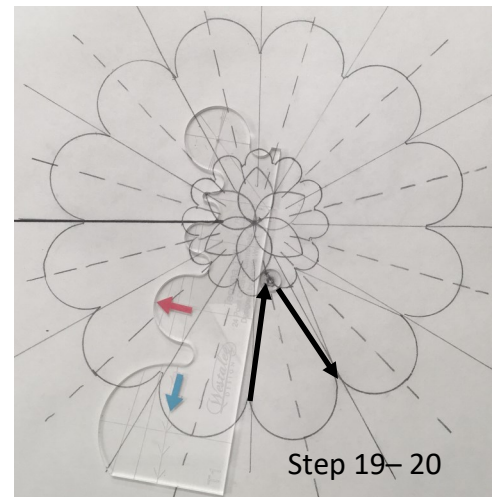

21. For this part of the design, use Tacoma Echo 2 on the 1/2" side. Reposition the thumb tack. Place the template so that the 1/2" marking in on the OUTER rim of the design. Bring up the bobbin thread in this position.

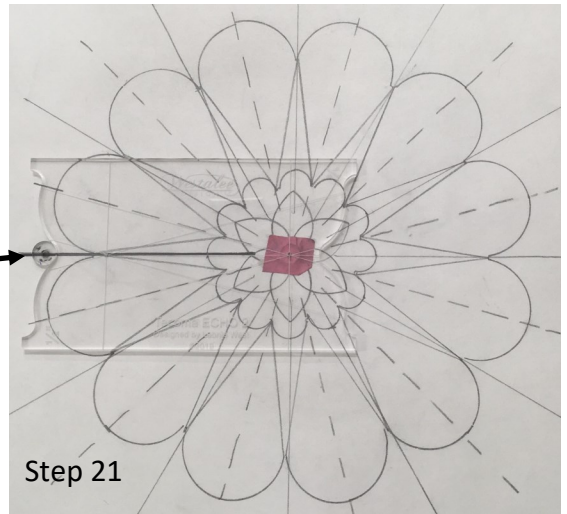

22. Stitch Counter Clockwise until stopped by the template.

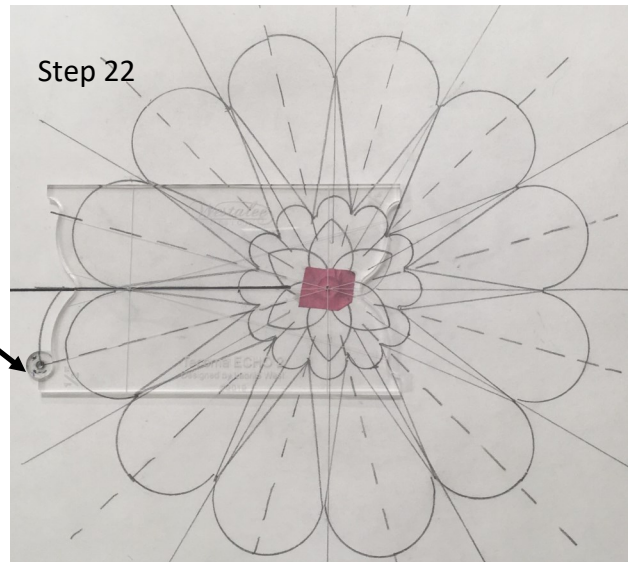

23. Rotate template Counter Clockwise, placing the CENTER etching on the next SOLID line. Stitch two complete echoes.

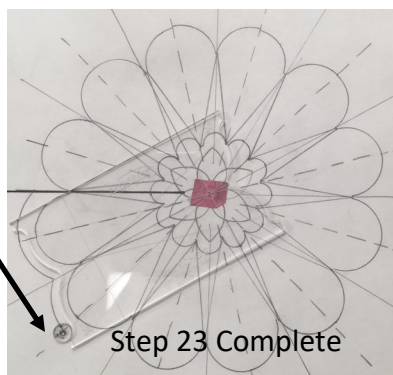
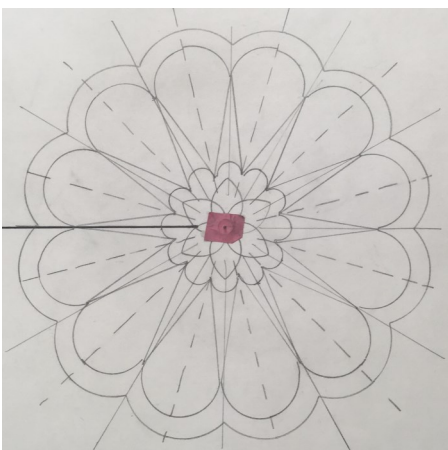
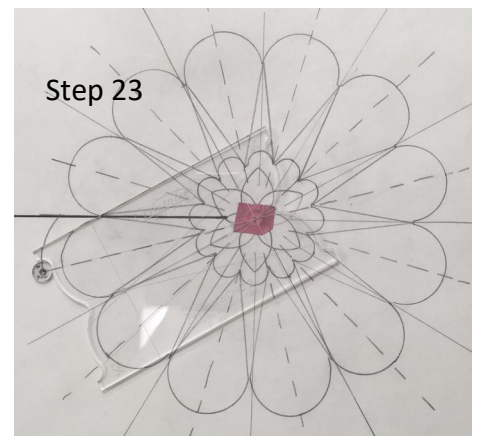

24. Continue to complete the 1/2" Echo. **SECURE THREADS.**

25. Use the Tacoma Echo 1, 1/2" template. Start by positioning the 1/2" to the OUTER Edge. Place the CENTER of the template on a DASHED LINE. Begin on the DASHED Line by bringing up the bobbin thread. Stitch Counter Clockwise until the template stops you. Rotate the template Counter Clockwise, lining up the CENTER of the template on the DASHED LINES each time. Stitch until back to the beginning. SECURE THREADS.

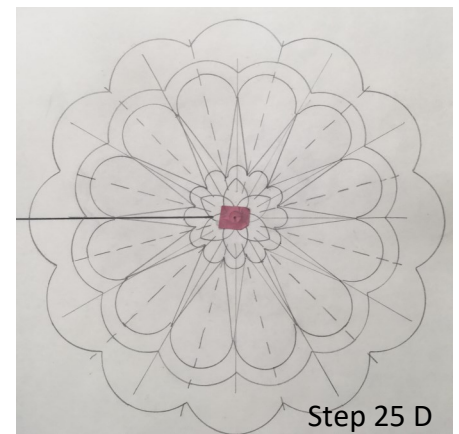
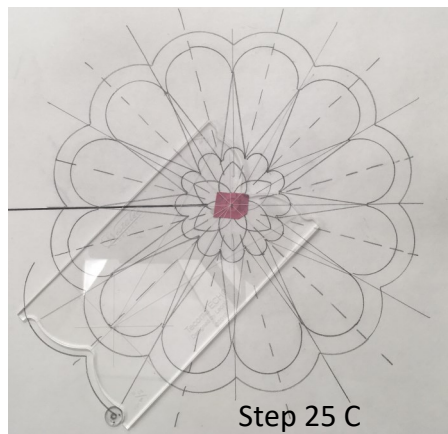
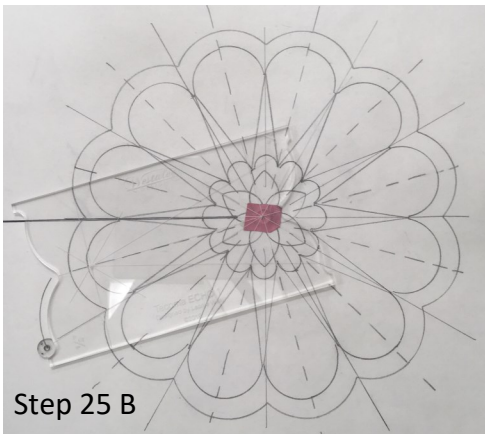
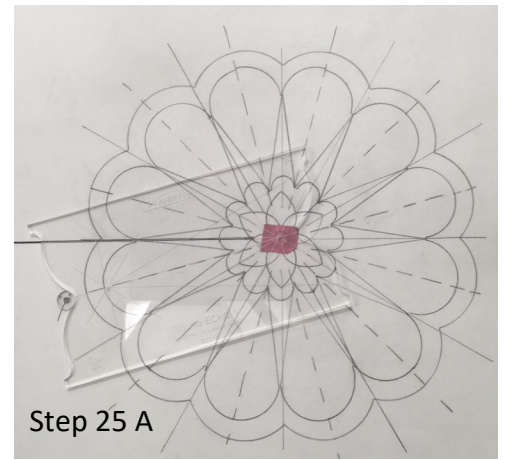

To TEMPLEE Quilt, follow the directions for preparing fabrics.

Determine the areas that you want to remove the top layer to expose the 'peeker' fabrics.



1. Fuse Heat 'n Bond Lite or TempLee Fuse to the WRONG side of the front fabric.
2. Layer:

Backing (wrong side up)

Batting

Peeker Fabric (right side up)



Spray Baste these layers together or fuse with Free Fuse by Quilters Select.

Place Front Fabric (remove paper layer of Heat 'n Bond Lite or TempLee Fuse) on top of Peeker Fabric - Heat 'n Bond Side DOWN.

3. Proceed with design. Stitch with Polyester Thread. 100% Cotton Thread tends to break due to the layer of Heat 'n Bond Lite.
4. After design is complete, use Snip EZE Scissors by Havel or Famore' to cut out the desired sections.
5. After you have completed the cutting, it is now time to FUSE the Design.
6. Continue with project as desired.

